

DIY Light Holder

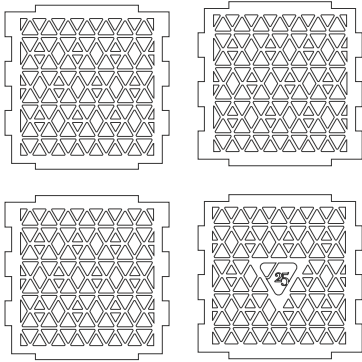

- 1 Arrange the side panels with alternate grooves as shown here.

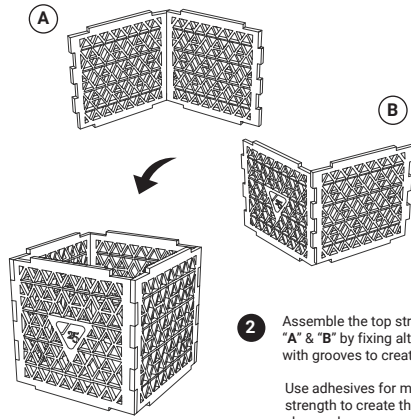

- 2 Assemble the top structures "A" & "B" by fixing alternative panels with grooves to create the box.

Use adhesives for more stability & strength to create the structure shown above.

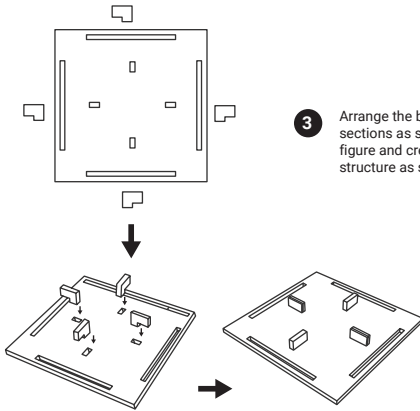

- 3 Arrange the bottom panel sections as shown in the figure and create the structure as shown below.

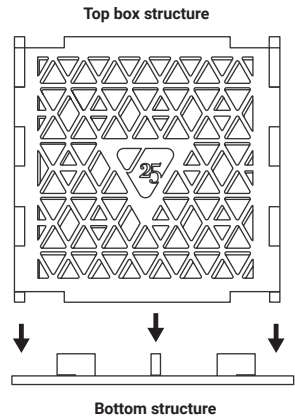

- 4 Fix the top structure in the slots given in the bottom panel.

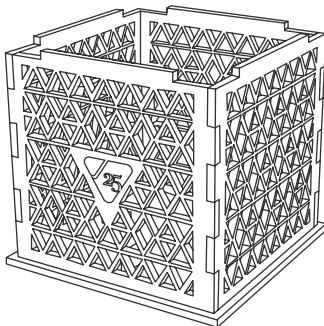

- 5 **Ta-daa!**
Your DIY light holder is complete.

NOTE:

While using the item as light holder

- * AVOID USING UNATTENDED FLAMES/CANDLES.
- * USE ONLY BATTERY LIT CANDLES.

